

**ArtiStar™**

**ES16 Metal Halide**  
Integral Ballast

# FLOODLIGHT

<b>PROJECT:</b>	
<b>TYPE:</b>	
<b>CATALOG NUMBER:</b>	
<b>SOURCE:</b>	
<b>NOTES:</b>	

## CATALOG NUMBER LOGIC



- Material**  
**Blank** - Aluminum  
**B** - Brass
- Series**  
**AR** - ArtiStar™
- Source**  
**ES20** - ES-16 Metal Halide (20W)  
**ES35** - ES-16 Metal Halide (35W)
- Housing**  
**TR** - Integral Ballast
- Lamp**  
**0** - By Others  
**276** - (20W) 12° Spot  
**277** - (20W) 25° Flood  
**279** - (20W) 40° Flood  
**310** - (35W) 25° Flood  
**311** - (35W) 12° Spot  
**312** - (35W) 40° Flood
- Finish**

Aluminum & Brass Finish			Brass Finish		Premium Finish		
Powder Coat Color	Satin	Wrinkle	Machined	MAC	ABP	CMG	RMG
Bronze	<b>BZP</b>	<b>BZW</b>	Polished	<b>POL</b>	<b>AMG</b> Aleutian Mountain Granite	<b>CRI</b> Cracked Ice	<b>SDS</b> Sonoran Desert Sandstone
Black	<b>BLP</b>	<b>BLW</b>	Mitique™	<b>MIT</b>	<b>AQW</b> Antique White	<b>CRM</b> Cream	<b>SMG</b> Sierra Mountain Granite
White (Gloss)	<b>WHP</b>	<b>WHW</b>			<b>BCM</b> Black Chrome	<b>HUG</b> Hunter Green	<b>TXF</b> Textured Forest
Aluminum	<b>SAP</b>	—			<b>BGE</b> Beige	<b>MDS</b> Mojave Desert Sandstone	<b>WCP</b> Weathered Copper
Verde	—	<b>VER</b>			<b>BPP</b> Brown Patina Powder	<b>NBP</b> Natural Brass Powder	<b>WIR</b> Weathered Iron
					<b>CAP</b> Clear Anodized Powder	<b>OCP</b> Old Copper	<i>Also available in RAL Finishes See submittal SUB-1439-00</i>

**Lens**  
**9** - Clear Lens (Standard)    **10** - Spread Lens\*    **12** - Soft Focus Lens\*    **13** - Rectilinear Lens\*

**Shielding**  
**11** - Honeycomb Baffle\*  
 \*Select 1 Lens or shielding option.

**Cap Style**  
**A** - 45°    **B** - 90°    **C** - Flush    **D** - 45° without Weep Hole (for Interior Use Only)    **E** - 90° without Weep Hole (for Interior Use Only)    **F** - 90° Cutoff with Flush Lens

**Base Height**  
**8** - 8" with Anchor Base (Standard)    **20** - 20" with Anchor Base  
**14** - 14" with Anchor Base    **26** - 26" with Anchor Base

**Input Volts**  
**120** - 120 Volt    **277** - 277 Volt

**Option**  
**PP** - Power Pipe option with 18" Stake    **WM** - Wall or ceiling Mount with 5" dia. canopy\*  
**SF** - Stability Flange (for use with Power Pipe™)    \* Base height limited to 8" max. with brass fixtures

## LAMP DATA

BK No.	Lamp Watts	Description	Rated Life	Center Beam Candlepower	CRI	CCT(K)
276	20	CMH20MR16/830/SP	12,000	9,000	81	3000
277	20	CMH20MR16/830/FL	12,000	9,000	81	3000
279	20	CMH20MR16/830/FL	12,000	1,500	81	3000
310	35	CMH35MR16/830/FL	10,000	5,500	90	3000
311	35	CMH35MR16/830/SP	10,000	16,000	90	3000
312	35	CMH35MR16/830/FL	10,000	3,000	90	3000

<h1>B-K LIGHTING</h1>	40429 Brickyard Drive • Madera, CA 93636 • USA 559.438.5800 • FAX 559.438.5900 www.bklighting.com • info@bklighting.com	SUBMITTAL DATE <b>12-6-11</b>	DRAWING NUMBER <b>SUB-1319-00</b>
-----------------------	---	----------------------------------	--------------------------------------

THIS DOCUMENT CONTAINS PROPRIETARY INFORMATION OF B-K LIGHTING, INC. AND ITS RECEIPT OR POSSESSION DOES NOT CONVEY ANY RIGHTS TO REPRODUCE, DISCLOSE ITS CONTENTS, OR TO MANUFACTURE, USE OR SELL ANYTHING IT MAY DESCRIBE. REPRODUCTION, DISCLOSURE OR USE WITHOUT SPECIFIC WRITTEN AUTHORIZATION OF B-K LIGHTING, INC. IS STRICTLY FORBIDDEN.

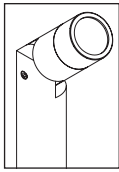

**ArtiStar™**

**ES16 Metal Halide**  
Integral Ballast

# FLOODLIGHT

<b>PROJECT:</b>	
<b>TYPE:</b>	

**"A/D" CAP**

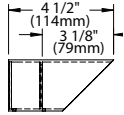

**"B/E" CAP**

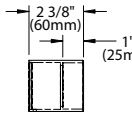

**"C" CAP**

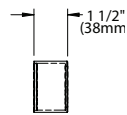

**"F" CAP**

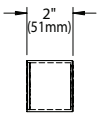

**STANDARD BASE**

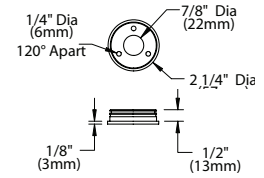

**WALL MOUNT CANOPY**

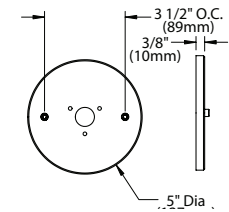

**POWER PIPE**

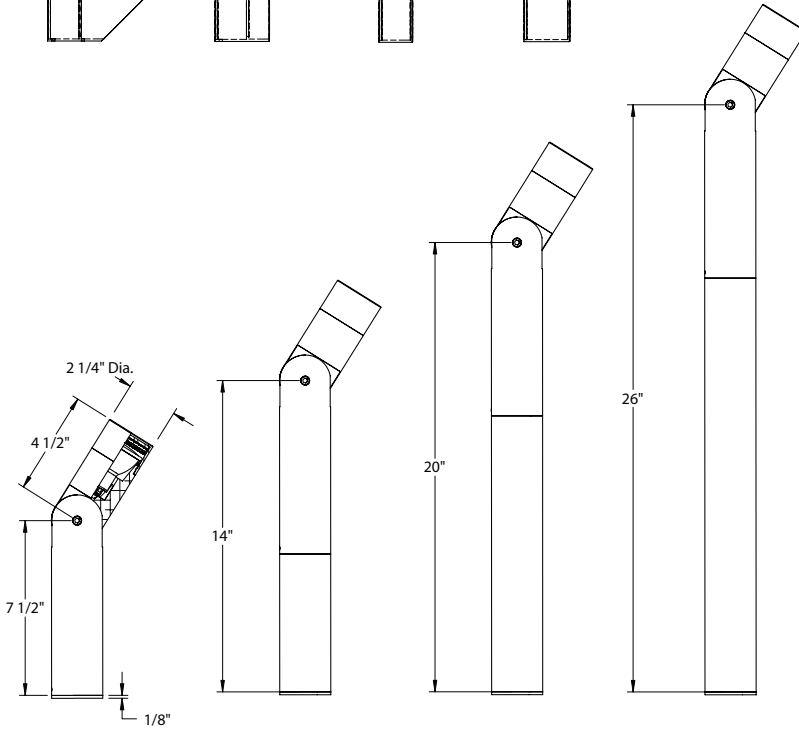
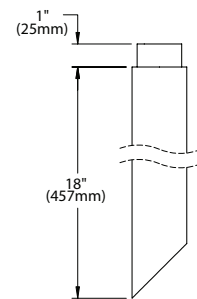

**ANCHOR BASE STANDARD MOUNT**

All dimensions indicated on this submittal are nominal. Contact Technical Sales if you require more stringent specifications.

## SPECIFICATIONS

**GreenSource Initiative™**

Metal and packaging components are made from recycled materials. Manufactured using renewable solar energy, produced onsite. Returnable to manufacturer at end of life to ensure cradle-to-cradle handling. Packaging contains no chlorofluorocarbons (CFC's). Use of this product may qualify for GreenSource efficacy and recycling rebate(s). Consult [www.bklighting.com/greensource](http://www.bklighting.com/greensource) for program requirements.

**Materials**

Furnished in Copper-Free Aluminum (Type 6061-T6), Brass (Type 360).

**Body**

Fully machined from solid billet. Unibody design provides enclosed, water-proof wireway and integral heat sink for maximum component life. Integral knuckle for maximum mechanical strength. High temperature, silicone 'O' Ring provides water-tight seal.

**Knuckle**

'Aim and Lock' knuckle is comprised of two components. The first is integral to the body and features an interior, machined taper. The second is machined from solid billet and features a second, reverse angle taper. The resultant mechanical taper-lock allows a full 180° vertical adjustment without the use of serrated teeth, which inherently limit aiming. High temperature, silicone 'O' Ring provides water-tight seal and compressive resistance to maintain fixture position. Design withstands 73 lb. static load prior to movement to ensure decades of optical alignment. Biaxial source control with 360° horizontal rotation in addition to vertical adjustment.

**Cap**

Fully machined. Accommodates [1] lens or louvre media. Choose from 45° cutoff ('A' or 'D'), 1" deep bezel with 90° cutoff ('B' or 'E'), flush lens ('C'), or 90° cutoff with flush lens ('F') cap styles. 'A' and 'B' caps include weep-hole for water and debris drainage. 'D' and 'E' caps exclude weep-hole and are for interior use only.

**Installation**

Machined anchor base with 7/8" dia. slip conduit hole and [3] 3/16" dia. anchor bolt holes (hardware by others). Available in standard increments to facilitate fixture elevation above grade. Optional 18" Power Pipe™ for direct burial into soil or concrete. Power Pipe™ additionally features optional 6" diameter, molded stability flange, which simplifies installation and projects into substrate to reinforce housing stability. Optional 5" dia. machined canopy permits mounting to junction box (gasket by others). 8" maximum base height for canopy-mounted brass fixture.

**Lens**

Shock resistant, tempered, glass lens is factory adhered to fixture cap and provides hermetically sealed optical compartment.

**Source**

For use with 35 watt maximum, GX10 base, ES16 metal halide lamps.

**Ballast**

Integral, electronic metal halide ballast. 120V, or 277V primary voltage.

**Wiring**

Teflon® coated wire, 18AWG, 600V, 250° C rated and certified to UL 1659 standard.

**Hardware**

Tamper-resistant, stainless steel hardware. Knuckle vertical aiming screw is additionally black oxide treated for additional corrosion resistance.

**Finish**

StarGuard® (Pat. Pend.), a RoHS compliant, 15 stage chromate-free process cleans and conversion coats aluminum components prior to application of Class 'A' TGIC polyester powder coating. Brass components are available in powder coat or handcrafted metal finish.

**Warranty**

5 year limited warranty.

**Listings**

ETL Listed to ANSI/UL Standard 1598. Certified to CAN/CSA Standard C22.2 No. 250. RoHS compliant. Suitable for indoor or outdoor use. Suitable for use in wet locations. Suitable for installation within 4' of the ground. IP 66 rated. Made in USA.



\*Teflon is a registered trademark of DuPont Corporation

<b>B-K LIGHTING</b>	40429 Brickyard Drive • Madera, CA 93636 • USA 559.438.5800 • FAX 559.438.5900 <a href="http://www.bklighting.com">www.bklighting.com</a> • <a href="mailto:info@bklighting.com">info@bklighting.com</a>	SUBMITTAL DATE	DRAWING NUMBER
		12-6-11	SUB-1319-00